

Water Feature assembly instructions

Please also refer to the assembly instructions for “models <1.7m in width – Backless”, which require assembling in conjunction with the water feature.

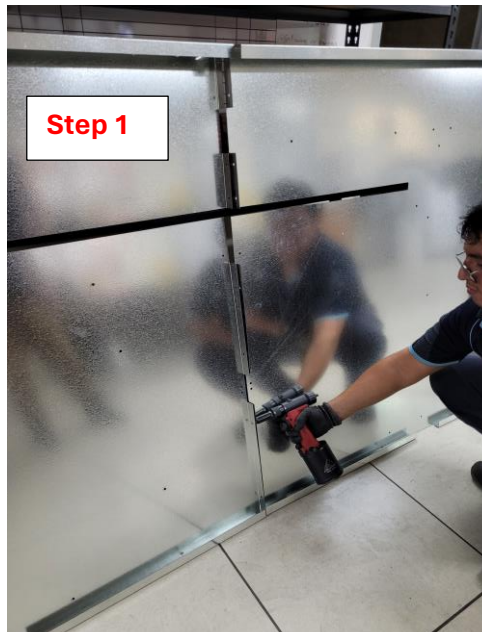

Use the pop rivets provided to attach the 2 front panels together by pop riveting along the internal returns.



Pop rivet the top strengthening bar under the internal return at the top of the front panels

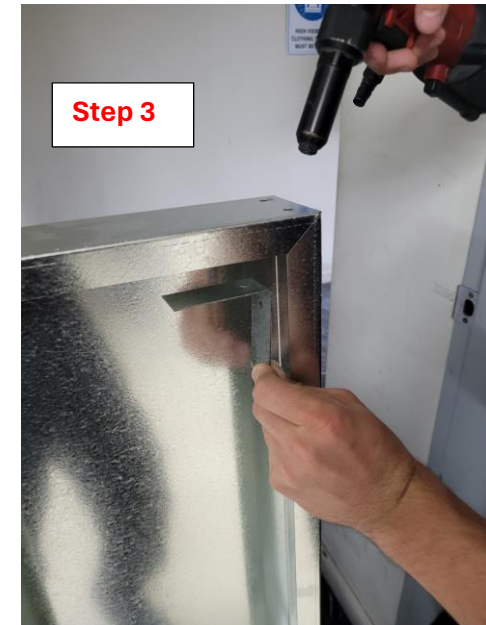

Pop rivet the 2 corner strengthening brackets to the front panel (2 in each corner)



Pop rivet the diagonal strengthening bar across the 2 front panels. The pop rivets are inserted from the front.



Pop rivet the horizontal strengthening bar across the 2 front panels and overlapping the diagonal bar AND the wall strips (*pls see assembly instructions for model <1.7m wide – backless*). The pop rivets are inserted from the front.

