

2200mm WIDE X
1100mm DEEP X
1800mm HIGH
BACKLESS

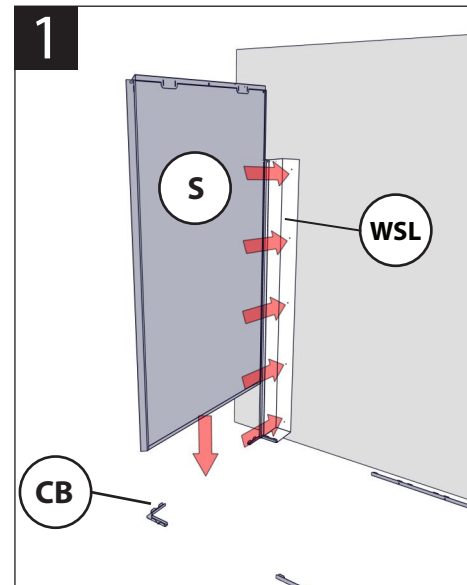

Locate slots on bottom of side panel and wall fixing strip and push down onto corner bracket. Fix wall fixing strip to wall using appropriate anchors.

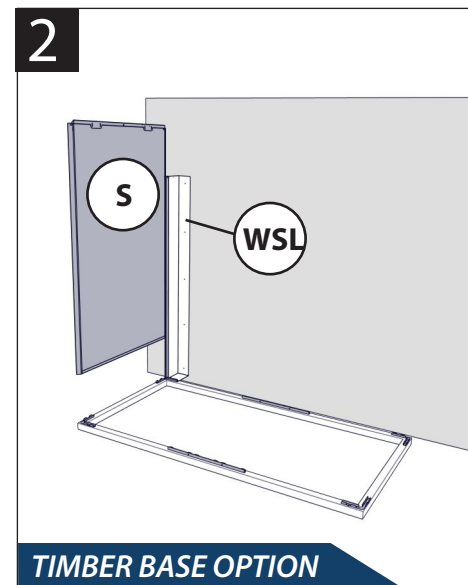

TIMBER BASE OPTION

If no concrete slab / other flat surface is available, use timber base frame as shown.

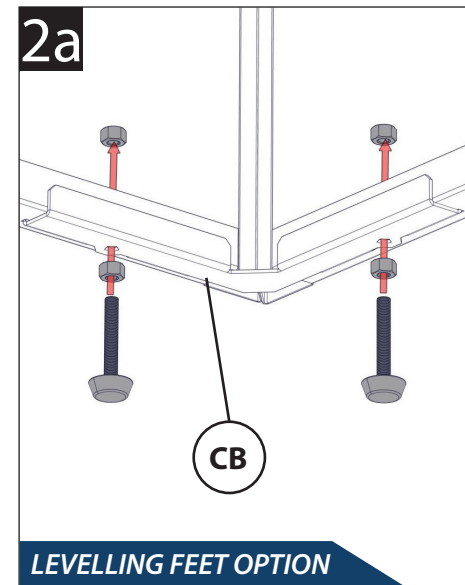

LEVELLING FEET OPTION

If installing on an uneven / unlevelled surface, please use the optional feet (through holes in bottom corners) to raise the box and adjust the nuts below / above the corner bracket to suit.

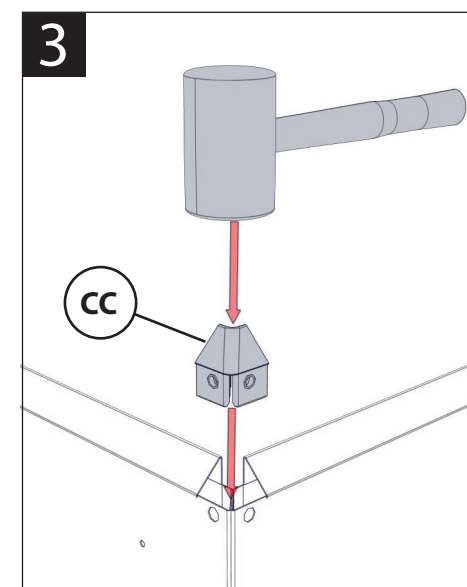

Now insert a plastic cap into the holes in the top of the panel to join them. Tap into place with a mallet.

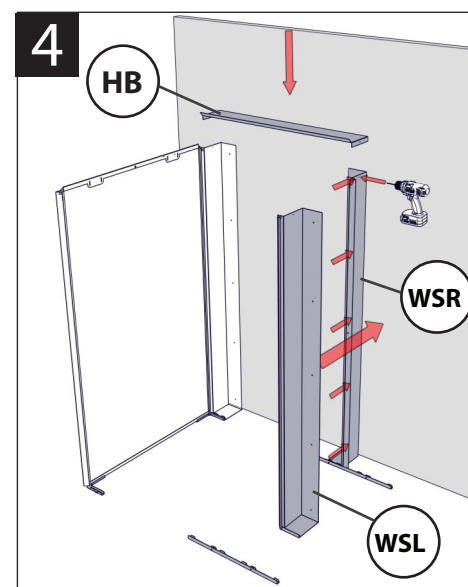

Now insert the other wall fixing strips onto the tabs of the corner and straight brackets. Screw horizontal bridge cover into Left and Right Wall Strips.

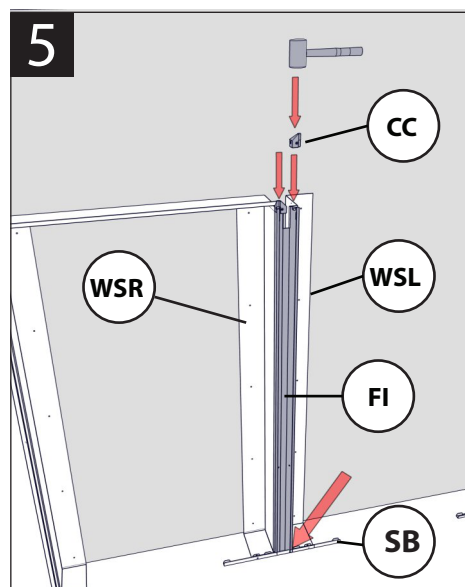

Insert the filler between the panels and slide into the straight bracket, ensuring slots at top of filler are in line with slots at top of wall fixing strips. Place the plastic caps into the wall fixing strips to join them to the filler.

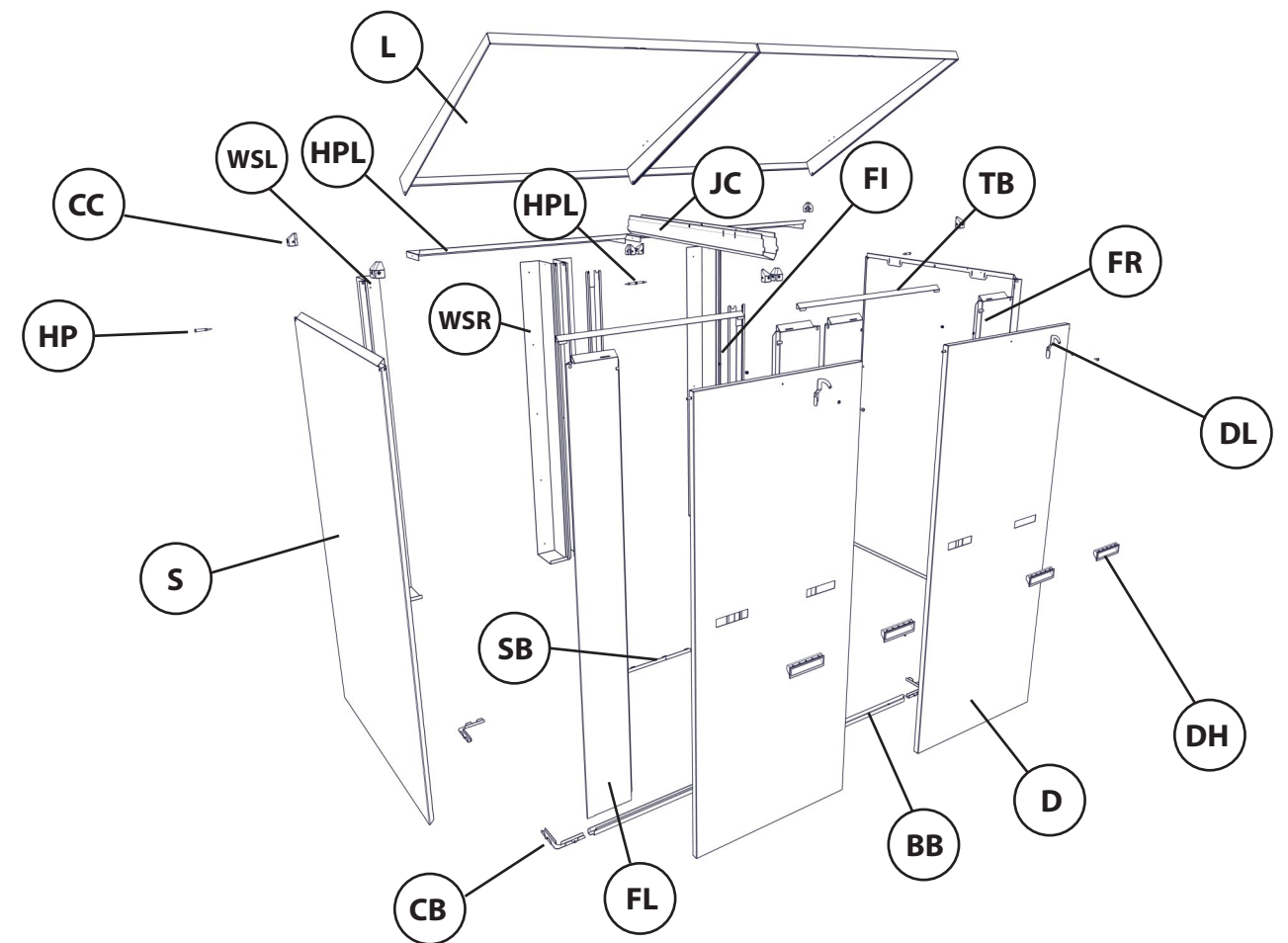

REQUIRED TOOLS

POWER DRILL

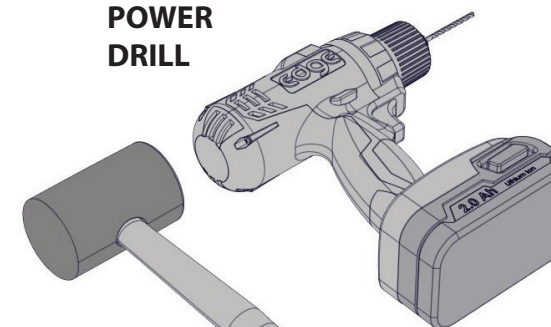

PHILLIPS SCREWDRIVER

RUBBER Mallet

Part No.	Description	Qty.
S	SIDE PANEL	2
WSL	WALL STRIP LEFT	2
WSR	WALL STRIP RIGHT	2
FL	FRONT PANEL LEFT	2
FR	FRONT PANEL RIGHT	2
CB	CORNER BRACKET	8
HB	HORIZONTAL BRIDGE COVER	2
L	LID	2
DL	DOOR LATCH	2
CC	CORNER CAP	8
D	REMOVABLE FRONT DOOR	2
DH	DOOR HANDLE	4
JC	JOINT CHANNEL	1
SB	STRAIGHT BRACKET	1
FI	FILLER	2
HP	HINGE PIN	2
HPL	LONG HINGE PIN	1
BB	BOTTOM BRACKET	2
TB	TOP BRACKET	2
BP	BASE PIN	8

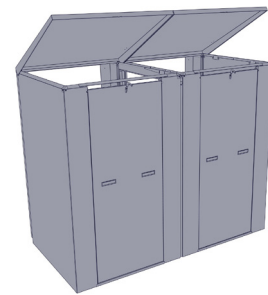

2200mm WIDE X
1100mm DEEP X
1800mm HIGH
BACKLESS

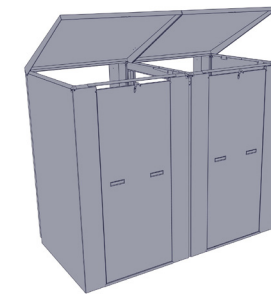

2200mm WIDE X
1100mm DEEP X
1800mm HIGH
BACKLESS

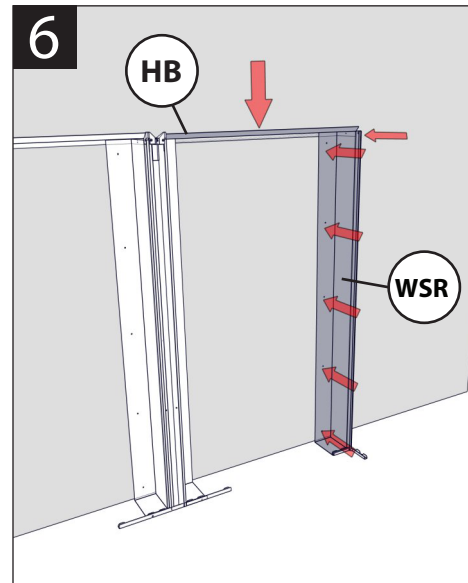

Slide the wall strip onto the corner bracket and attach to wall using appropriate fixings.

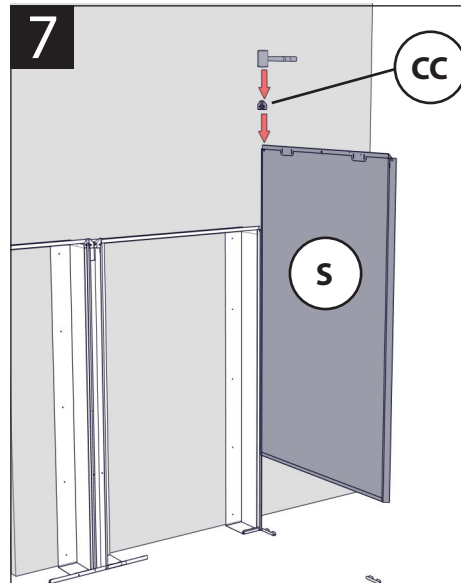

Slide the side panels into position and insert the filler and caps.

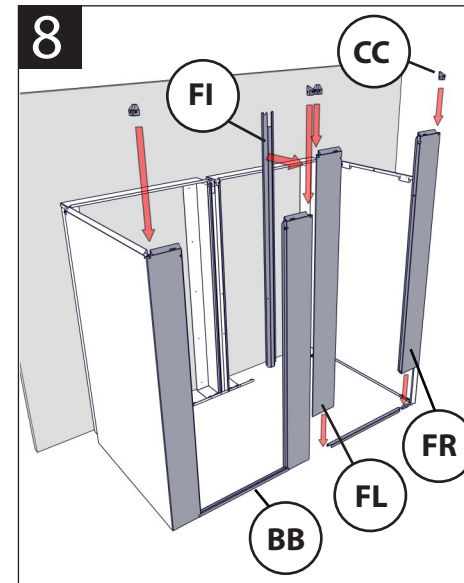

Slide the front panels into position in the bottom brace and insert the filler and caps.

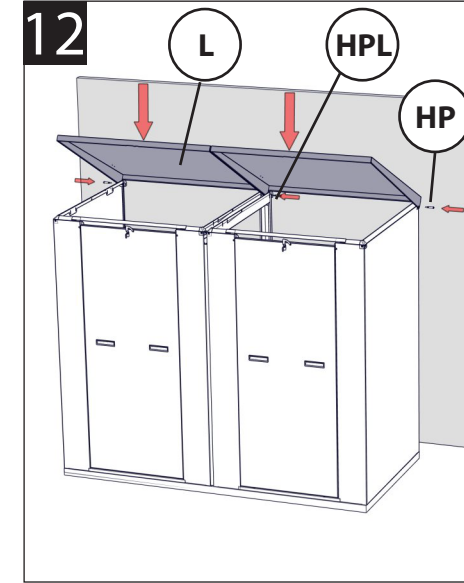

Attach lids to the unit with hinge pins. Align pins with holes and tap into place with a mallet. For the central join, tap the centre hinge pin through both top lids and corner caps.

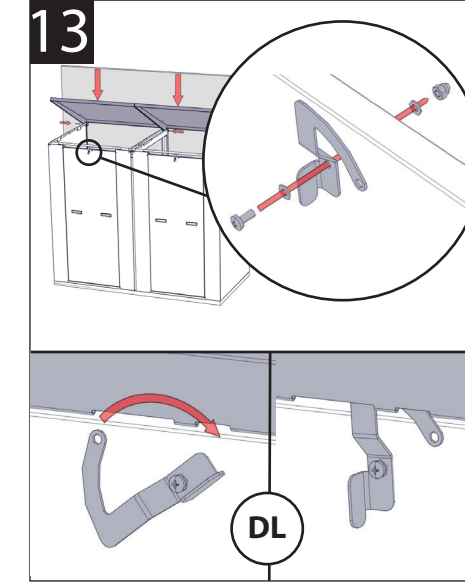

Attach the latch to the door using the supplied screw/washer/nut as per above. Rotate the Latch clockwise to "lock" into the top lid.

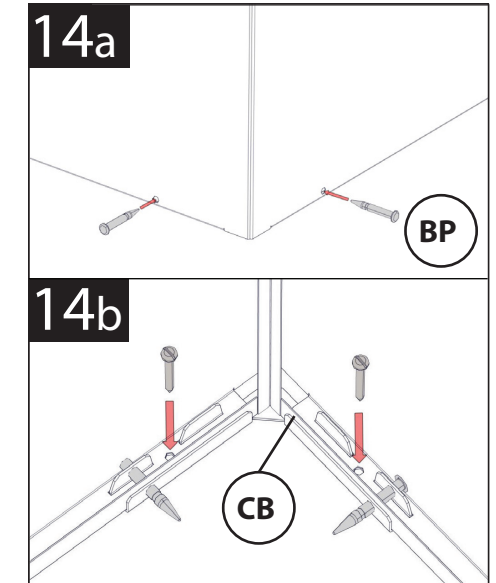

Push base pins into holes in the bottom edge of outer panels and through corner bracket (a). Anchor box to timber base frame as shown or concrete slab / other flat surface (b). Do this for for all 4 corners.

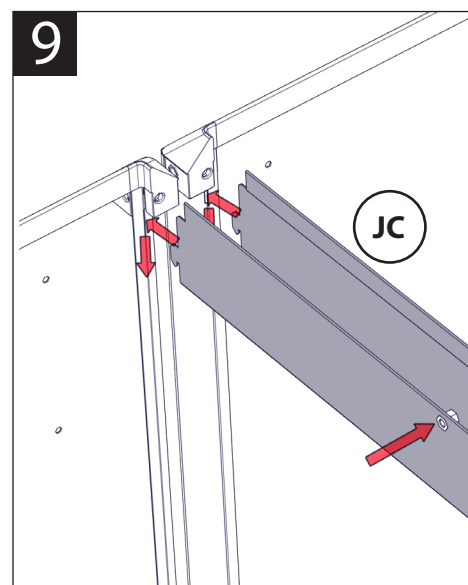

Now it's time to attach the joint channel into the rear and front panels. Push tabs into the slots (through fillers and rear/front panels) and then push down to lock. Ensure joint channel nut is orientated towards the rear as shown.

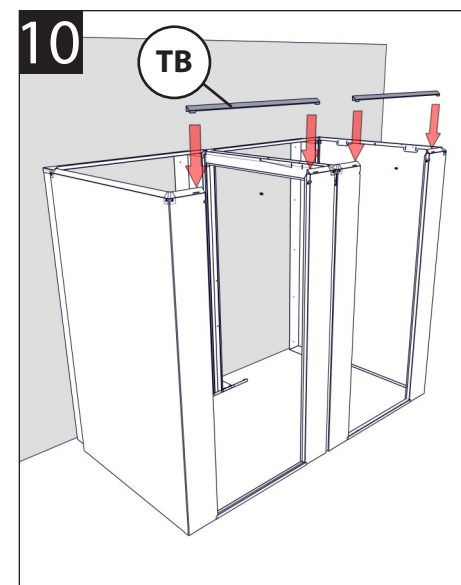

Insert Top Brace into slots in Front Left and Front Right Panels.

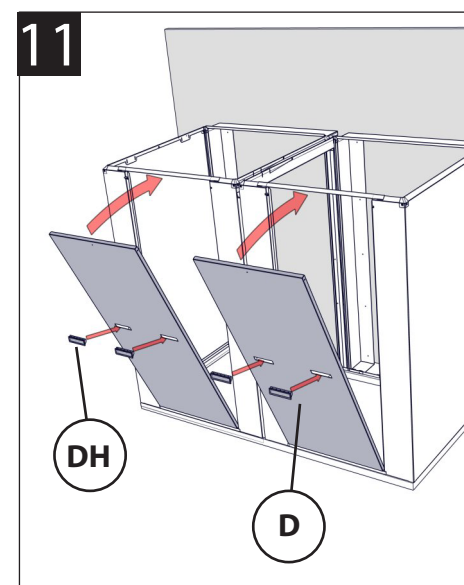

Insert the handles into the door until a "click" is heard. Place the removable front door into the panel by placing the lip of the door over the front panel step. Insert the door by aligning the studs on the side with the slots in the front panel. Push in slightly and then down.



6 Carolyn Street, Silverwater , NSW 2128
T: (02) 9620 5430 E: info@acousticbox.com.au W: www.acousticbox.com.au

For our **3D Assembly Instructions** please scan the QR code below or go to:

<https://www.acousticbox.com.au/html/acoustic-box-301118/index.html>

