

# THE ACOUSTIC BOX

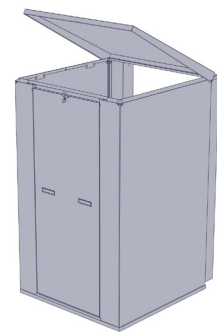

1100mm WIDE X  
1100mm DEEP X  
1800mm HIGH  
BACKLESS VERSION

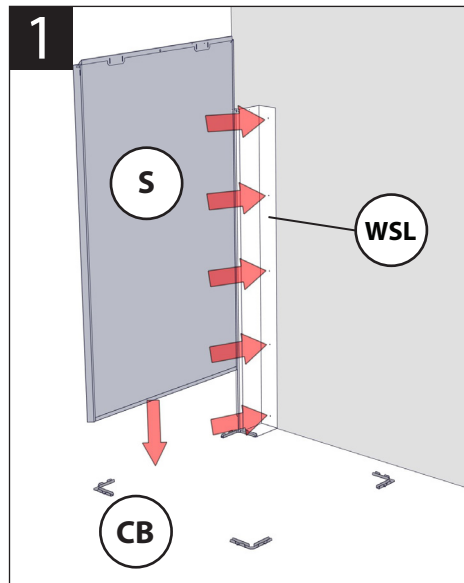

Locate slots on bottom of side panel and wall fixing strip and push down onto corner bracket. Fix wall fixing strip to wall using appropriate anchors.

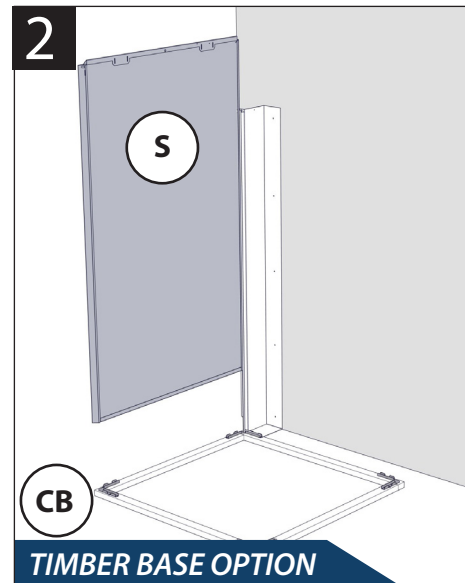

Alternatively, use timber base frame as shown.

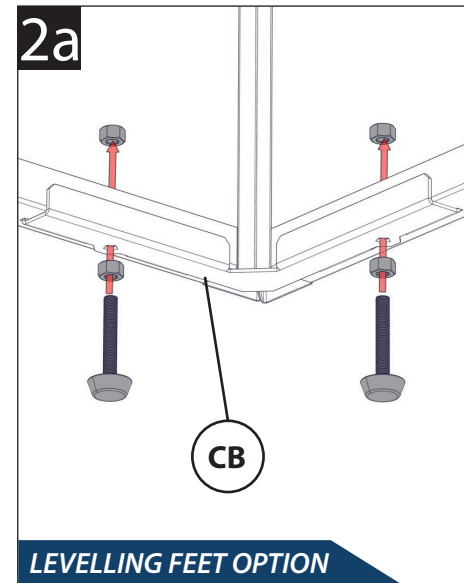

If installing on an uneven / unlevelled surface, please use the optional feet (through holes in bottom corners) to raise the box and adjust the nuts below / above the corner bracket to suit.

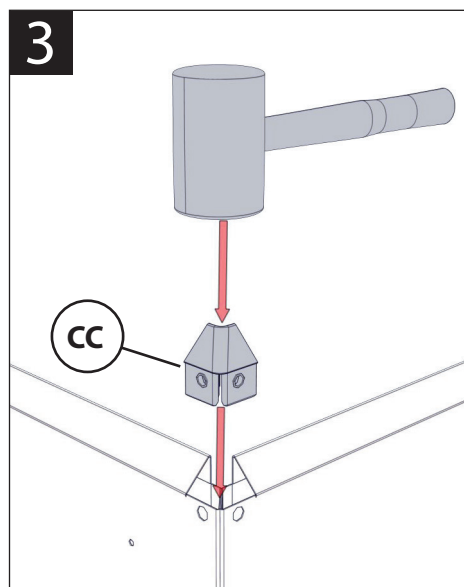

Now insert a plastic cap into the holes in the top of the panel to join them. Tap into place with a mallet.

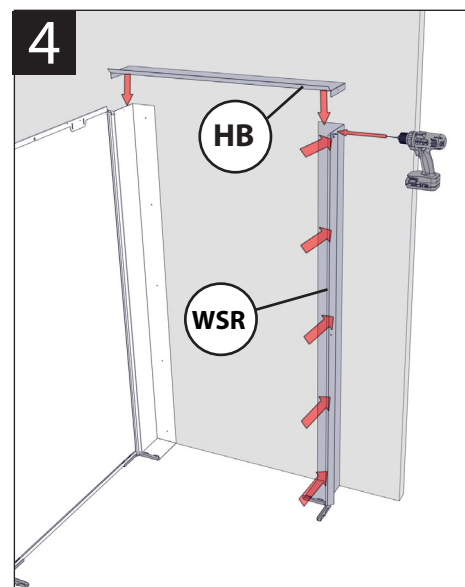

Install the Horizontal Bridge Cover, installed on the outside of the wall fixings strips. Use 2 metal tek screws to attach the horizontal bridge cover to the wall fixings strips. Fix the wall fixing strips to the wall using appropriate wall fixing anchors through the pre drilled holes.

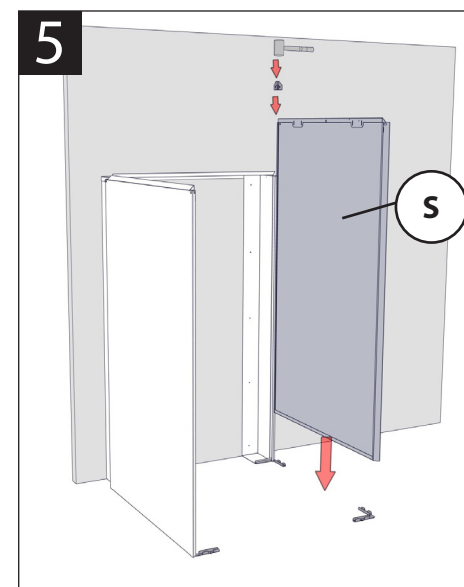

Align the slots into the front panel and slide into position. Insert the last 2 caps.

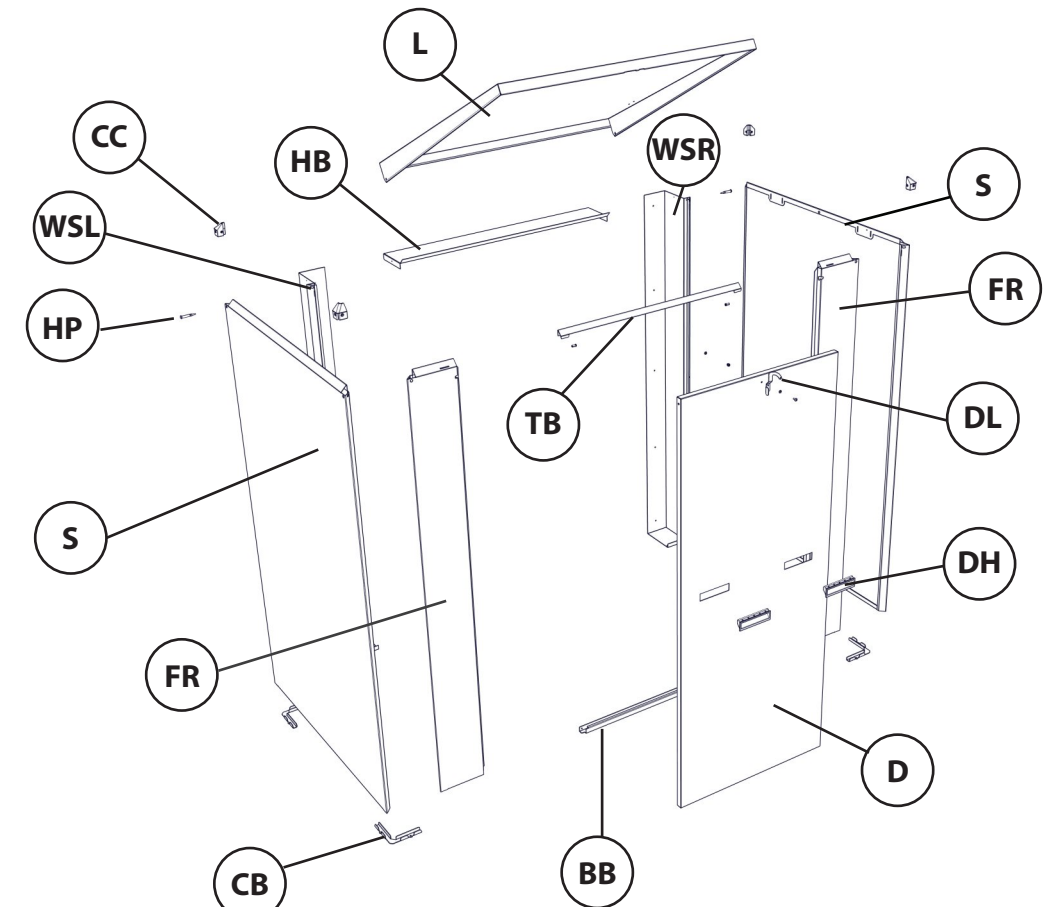

Part No.	Description	Qty.
S	SIDE PANEL	2
WSL	WALL STRIP LEFT	1
WSR	WALL STRIP RIGHT	1
FL	FRONT PANEL LEFT	1
FR	FRONT PANEL RIGHT	1
D	REMOVABLE FRONT DOOR	2
L	TOP DOOR	1
CB	CORNER BRACKET	4
HP	HINGE PIN	2
DL	DOOR LATCH	2
CC	CORNER CAP	4
BP	BASE PIN	8
DL	DOOR LATCH	1
DH	DOOR HANDLE	2
TB	TOP BRACE	1
BB	BOTTOM BRACE	1
HB	HORIZONTAL BRIDGE COVER	1

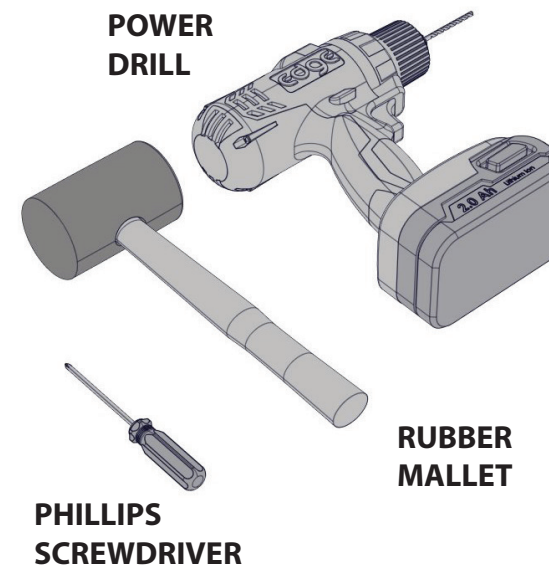

# THE ACOUSTIC BOX

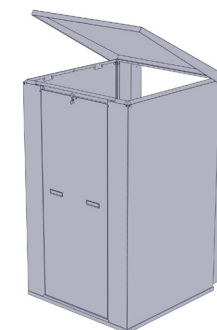

MODEL 1800H  
BACKLESS

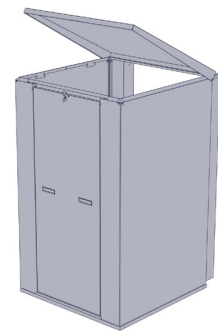

1100mm WIDE X  
1100mm DEEP X  
1800mm HIGH  
BACKLESS VERSION

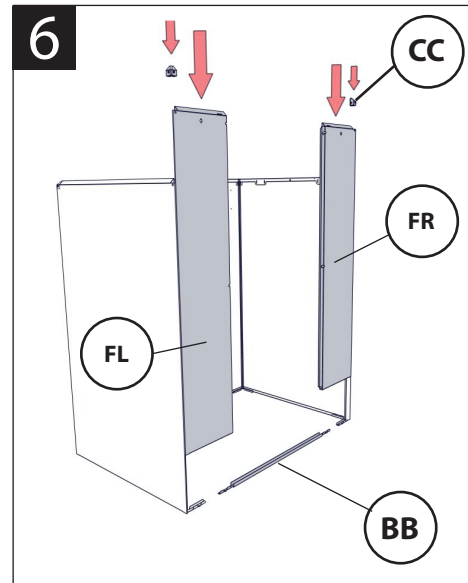

Slot Front Left and Front Right panels into the Lower Brace and Corner Brackets. Tap Corner Caps into place with a mallet.

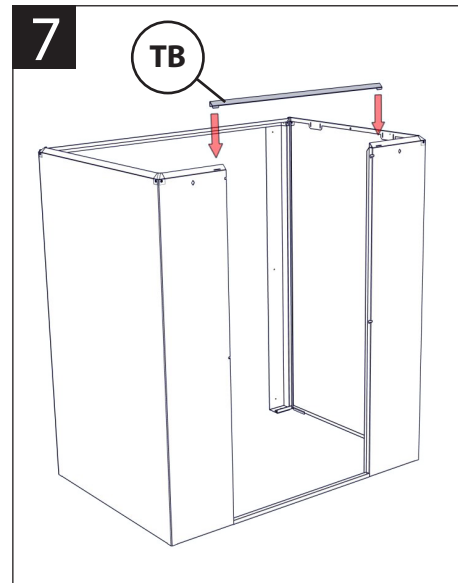

Insert Top Brace into slots in Front Left and Front Right Panels.

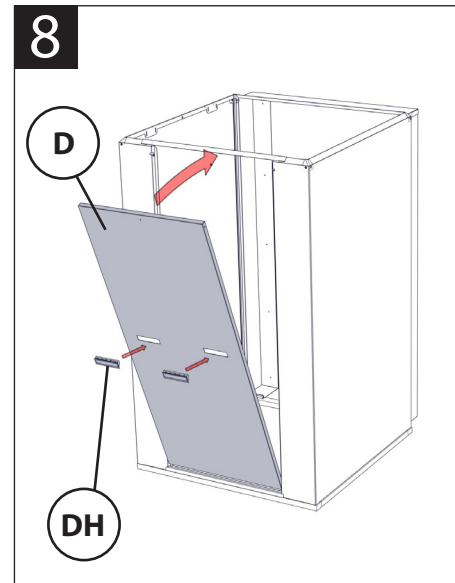

Insert the handles into the door until a "click" is heard. Place the removable front door into the panel by placing the lip of the door over the front panel step. Insert the door by aligning the studs on the side with the slots in the front panel. Push in slightly and then down.

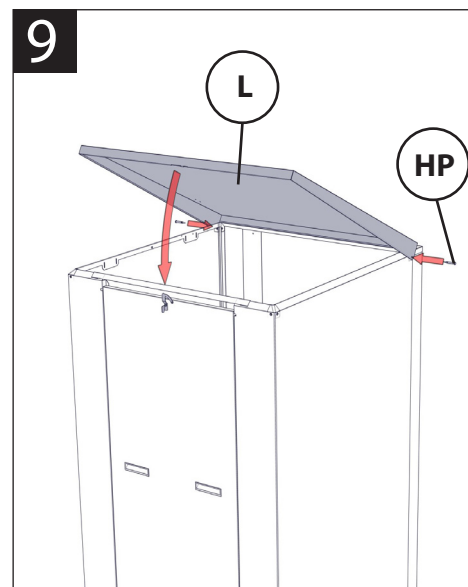

Attach top door to unit with hinge pins. Align pins with holes and tap into place with a mallet.

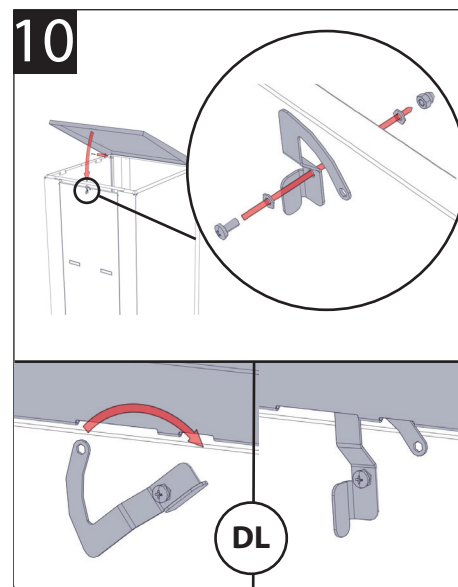

Attach the latch to the door using the supplied screw/washer/nut as per above. Rotate the Latch clockwise to "lock" into the top lid.

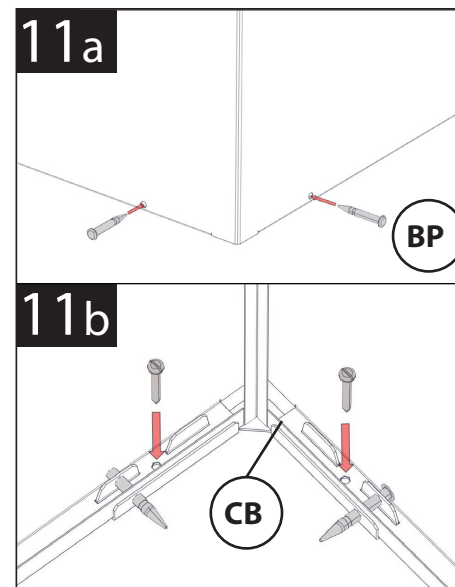

Push base pins into holes in the bottom edge of outer panels and through corner bracket (a). Anchor box to timber base frame as shown or concrete slab / other flat surface (b). Do this for for all 4 corners.

For our **3D Assembly Instructions** please scan the QR code below or go to:

<https://www.acousticbox.com.au/html/acoustic-box-301118/index.html>

