

BACKLESS  
>1.7m Models

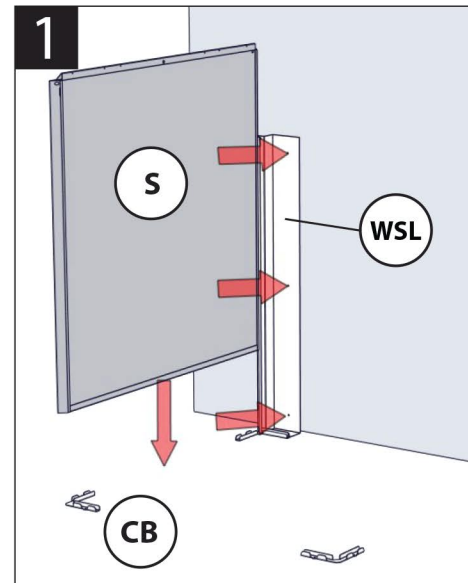

Locate slots on bottom of side panel and wall fixing strip and push down onto corner bracket. Fix wall fixing strip to wall using appropriate anchors.

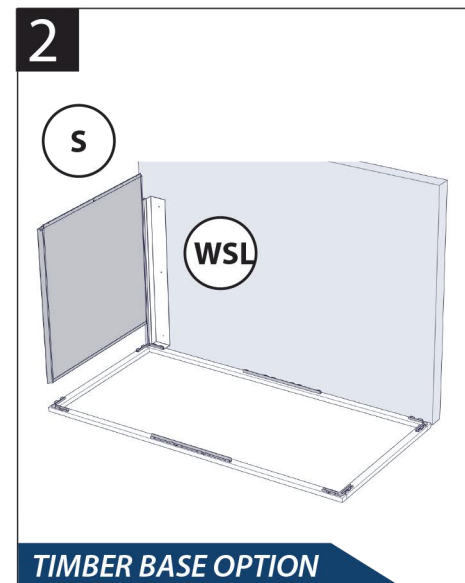

**TIMBER BASE OPTION**

If no concrete slab / other flat surface is available, use timber base frame as shown.

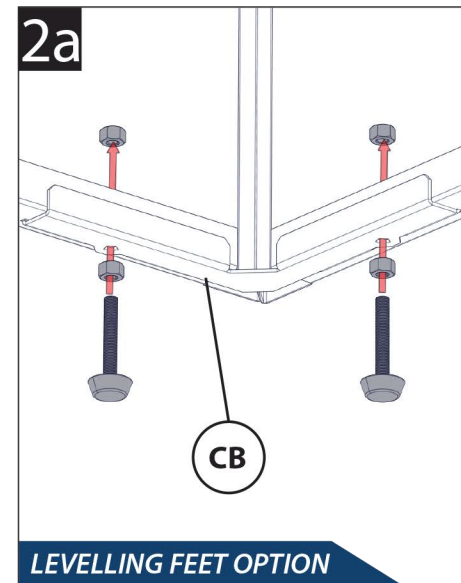

**LEVELLING FEET OPTION**

If installing on an uneven / unlevelled surface, please use the optional feet (through holes in bottom corners) to raise the box and adjust the nuts below / above the corner bracket to suit.

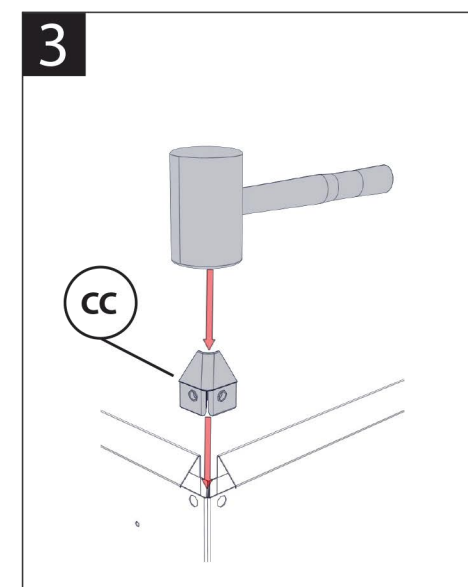

Now insert a plastic cap into the holes in the top of the panel to join them. Tap into place with a mallet.

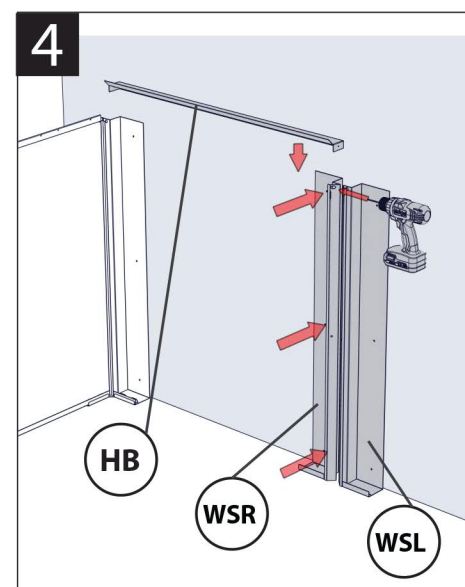

Now insert the other wall fixing strips onto the tabs of the corner and straight brackets.

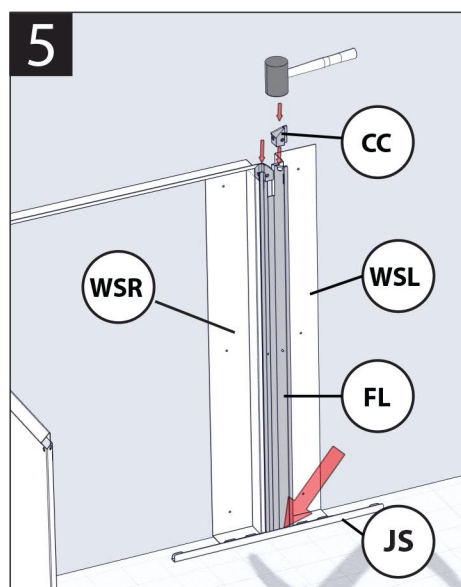

Insert the filler between the panels and slide into the straight bracket, ensuring slots at top of filler are in line with slots at top of wall fixing strips. Place the plastic caps into the wall fixing strips to join them to the filler.

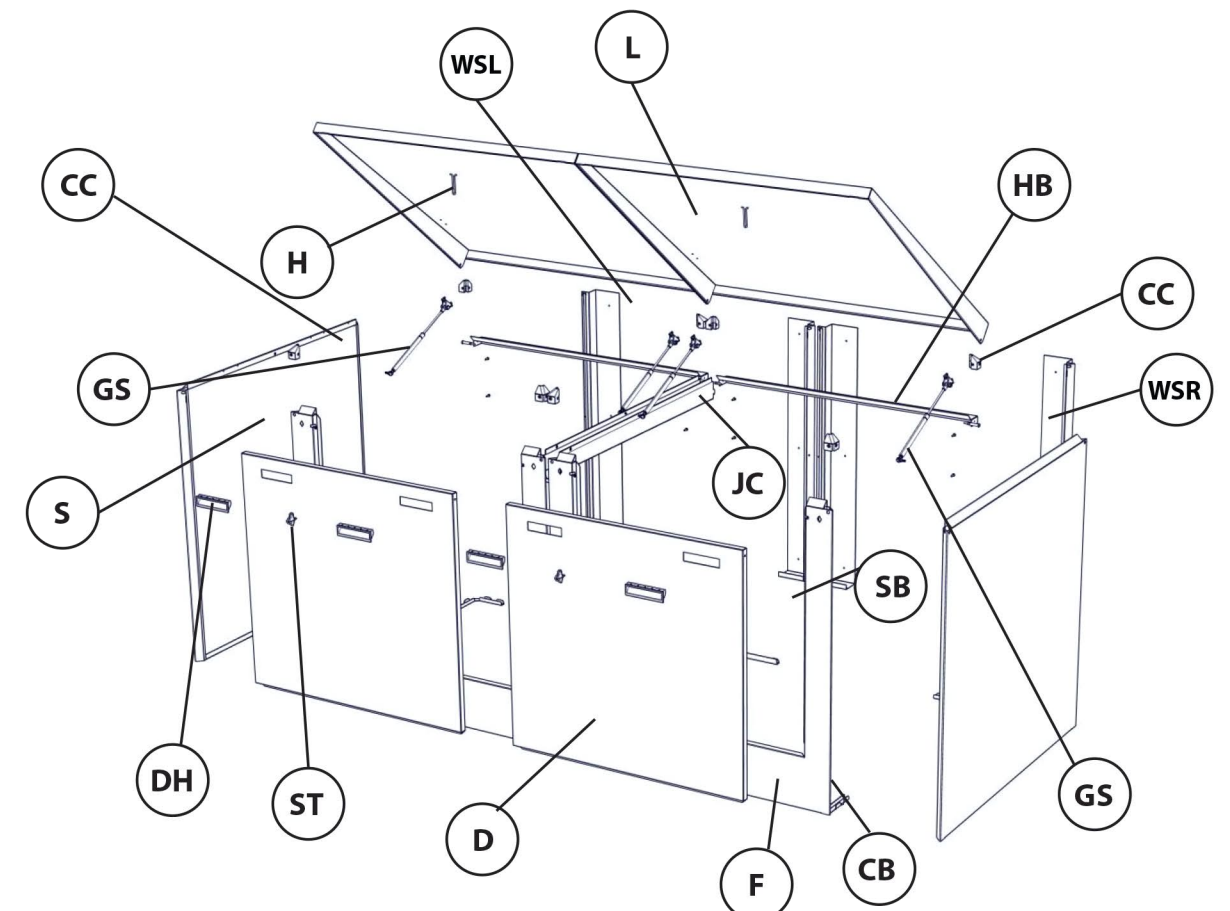

## REQUIRED TOOLS

**POWER DRILL**

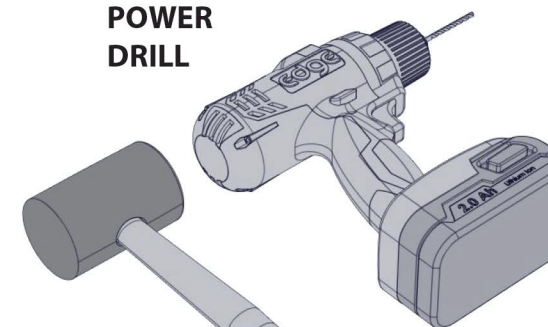

**PHILLIPS SCREWDRIVER**

**RUBBER Mallet**

Part No.	Description	Qty.
S	SIDE PANEL	2
F	FRONT PANEL	2
D	REMOVABLE FRONT DOOR	2
L	LID	2
CB	CORNER BRACKET	4
HP	HINGE PIN	2
GS	GAS STRUT	4
H	HASP	2
CC	PLASTIC CAP	8
ST	STAPLE	2
DH	DOOR HANDLE	4
WSL	WALL FIXING STRIP LEFT	2
WSR	WALL FIXING STRIP RIGHT	2
HB	HORIZONTAL BRIDGE COVER	2
JC	JOINT CHANNEL	1
SB	STRAIGHT BRACKET	2
FL	FILLER	2
HPL	LONG HINGE PIN	1

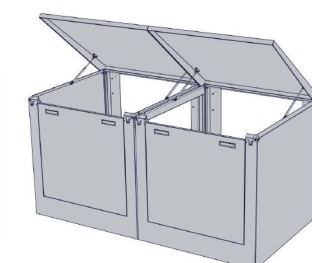

BACKLESS  
>1.7m Models

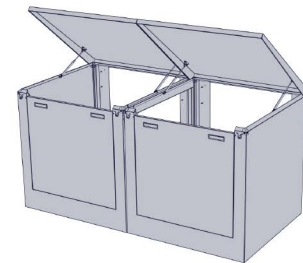

BACKLESS  
>1.7m Models

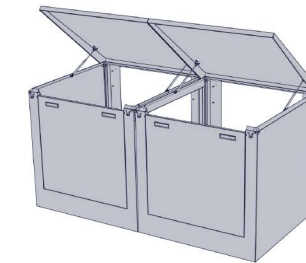

BACKLESS  
>1.7m Models  
+  
Any Other Models >2.2m

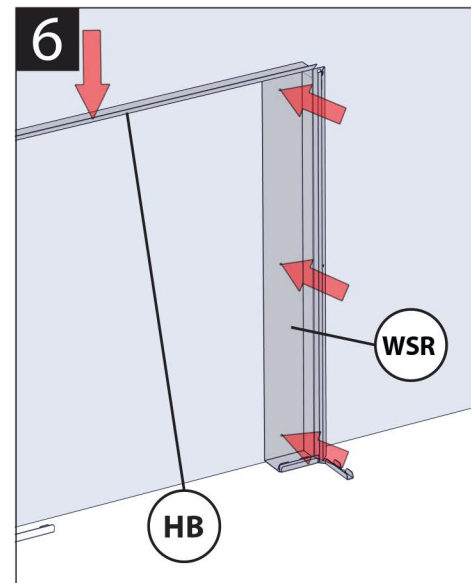

Slide the wall strip onto the corner bracket and attach to wall using appropriate fixings.

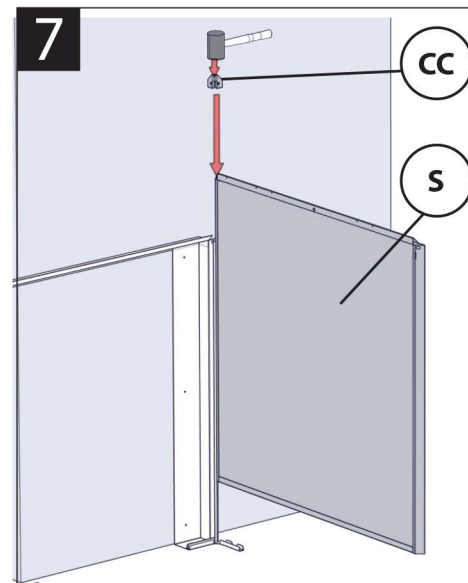

Slide the side panels into position and insert the filler and caps.

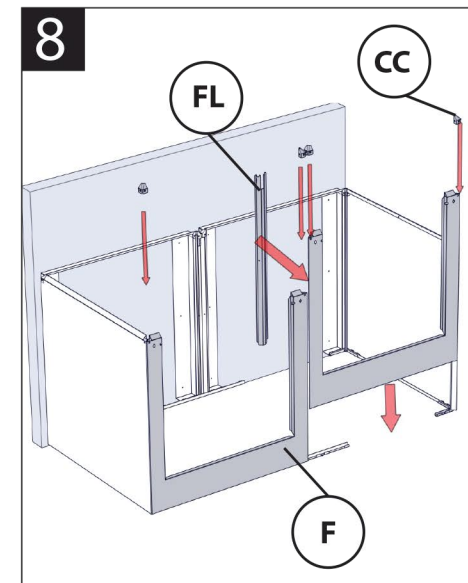

Slide the front panels into position and insert the filler and caps.

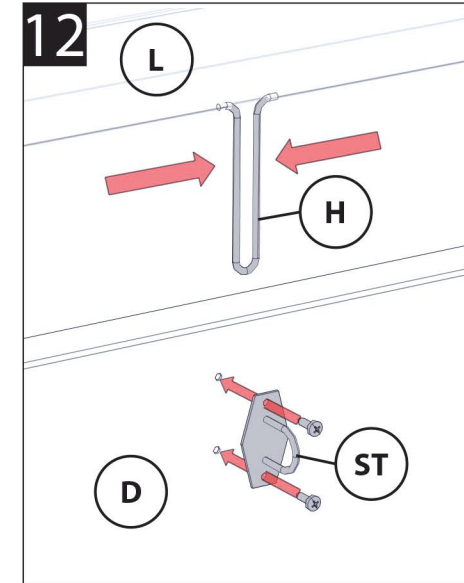

Insert staple into slot into top lid by pinching sides. Insert screws through hasp into removable door.

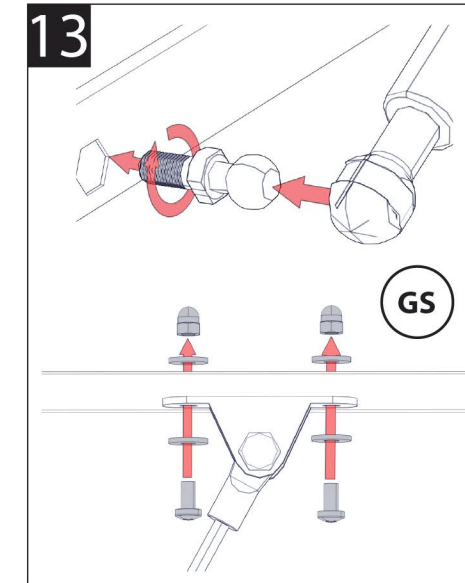

Attach gas struts to the side panel by attaching ball bearing first. Now push the struts onto the ball bearing. Insert bolt and washer into the faceplate of the strut and through the predrilled holes in the top door and secure with the dome nuts provided,

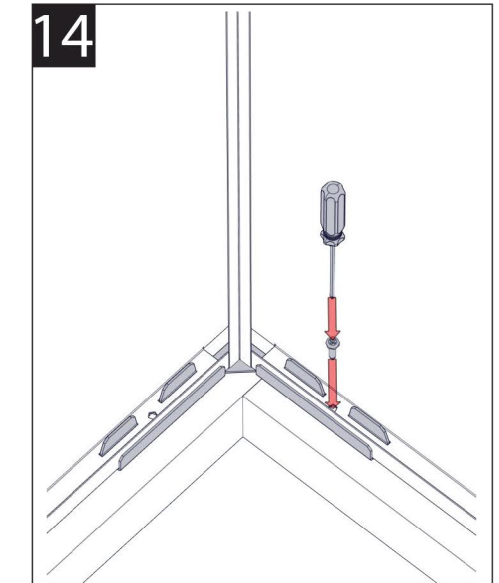

Anchor box to timber frame as shown or concrete slab / other flat surface.

**IF YOUR MODEL IS >2.7m WIDE, THEN REPEAT ABOVE INSTRUCTIONS**

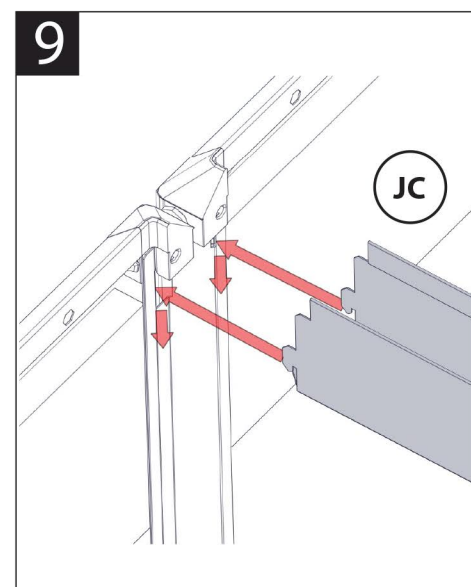

Now it's time to attach the joint channel into the wall strips and front panels. Push tabs into the slots (through fillers and wall strips / front panels) and then push down to lock.

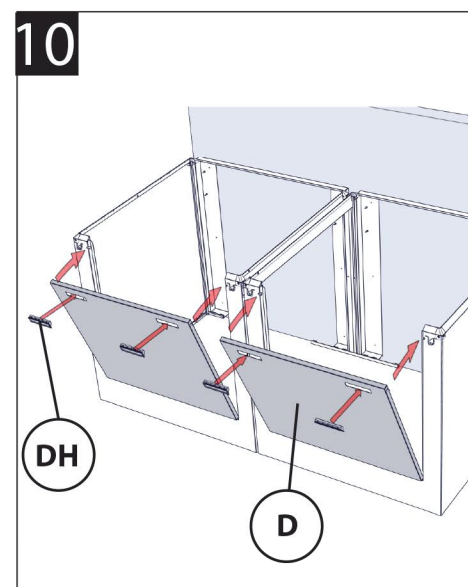

Insert the handles into the door until a "click" is heard. Place the removable front door into the panel by placing the lip of the door over the front panel step. Insert the door by aligning the studs on the side with the slots in the front panel. Push in slightly and then down.

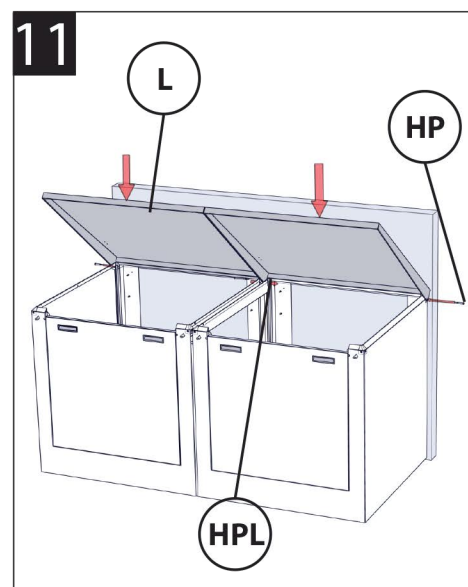

Attach lids to the unit with hinge pins. Align pins with holes and tap into place with a mallet. For the central join, tap the centre hinge pin through both top lids and corner caps.



6 Carolyn Street, Silverwater , NSW 2128  
T: (02) 9620 5430 E: [info@acousticbox.com.au](mailto:info@acousticbox.com.au) W: [www.acousticbox.com.au](http://www.acousticbox.com.au)

For our **3D Assembly Instructions** please scan the QR code below or go to:

<https://www.acousticbox.com.au/html/acoustic-box-301118/index.html>

